



## PUMP COMPANY

### Zoeller Family of Water Solutions™

#### Model 910-0053 Packaged Sewage Pumping System

##### 912 Sewage Systems include:

- (1) 50mm solids sewage ejector pump
- (1) 610mm x 610 poly moulded basin
- (1) Poly Structural Foam cover
- Internal 50mm PVC discharge pipe work Kit

##### Pump Features:

- Cast iron construction (models 267)
- Automatic configuration available
- Full 50mm solids capacity
- Thermal overload protection
- Non-clogging vortex impeller

##### Basin Features:

- 610mm depth for easier installation in troublesome areas
- 180 litre capacity
- 114 litre capacity below 4" inlet
- Vertical support ribs help eliminate stuck float switches
- Anti-flotation device helps to eliminate basin from 'floating'
- 360° moulded handle acts as secondary anti-flotation device
- 1 x 110mm pre-drilled inlet
- 7 x additional flat areas for inlet installation (field drilled)
- Moulded torque stops for added pump support
- One-piece moulded PSF cover with integrated moulded foam seal
- Ribbed reinforced cover to provide additional strength and stability
- Stainless steel cover bolts and hardware
- High water alarms available
- Stackable for storage/shipping
- Job ready for easy installation

##### Pump Specifications:

- 1/2 HP (267)
- 50Hz 240 Volts
- 50mm NPT discharge with 50mm solids capacity

##### Basin Specifications:

- Poly moulded basin with PSF cover
- 180 litres capacity (114 litre below inlet)
- 1 x 4" inlet (predrilled coupling by others)
- Integral foam seal
- Stainless steel bolt kit

##### Application areas:

- Small extensions
- Small conversions
- Treatment plants
- Septic tanks



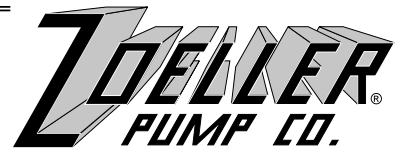

## Models 266, 267 Series

### SEWAGE/EFFLUENT OR DEWATERING PUMP

#### MATERIAL SPECIFICATIONS:

- 1/2 HP, 220V, 1 Ph, 50 Hz.
- Non-Clogging Vortex Impeller design.
- Passes 51 mm spherical solids.
- 2" NPT female vertical discharge.
- Automatic reset thermal overload protection.
- Float operated 2-pole mechanical switch available.
- Durable cast iron construction with corrosion resistant powder coated epoxy finish.
- Stainless steel screws, bolts, float rod, handle, guard and switch arm assembly.
- Automatic or Nonautomatic.

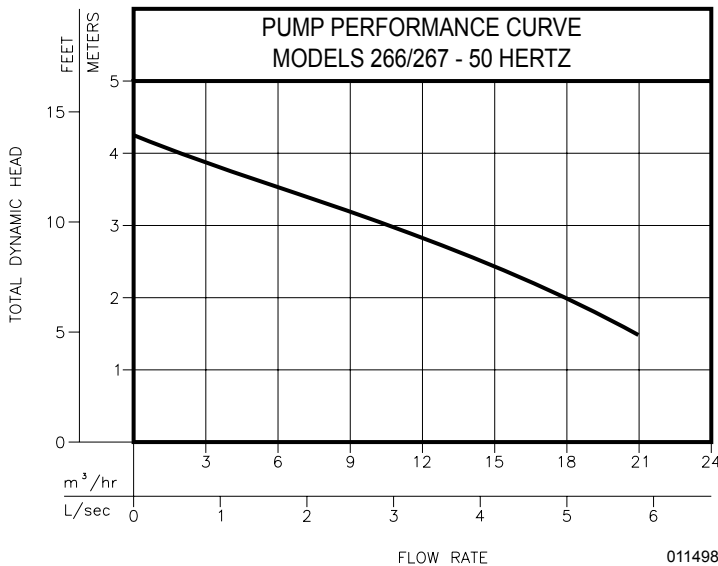

*"QUALITY PUMPS SINCE 1939"*

All models completely submersible and hermetically sealed.

Model	Volts	Ph	Mode	Input kw	Amp
U266	220	1	Auto	0.7	4.4
V266	220	1	Nonauto	0.7	4.4
U267	220	1	Auto	0.7	4.4
V267	220	1	Nonauto	0.7	4.4



DRAWING REVISIONS				
LTR	BY	DATE	ECO #	DESCRIPTION
A	DD	6/13/08		RELEASE

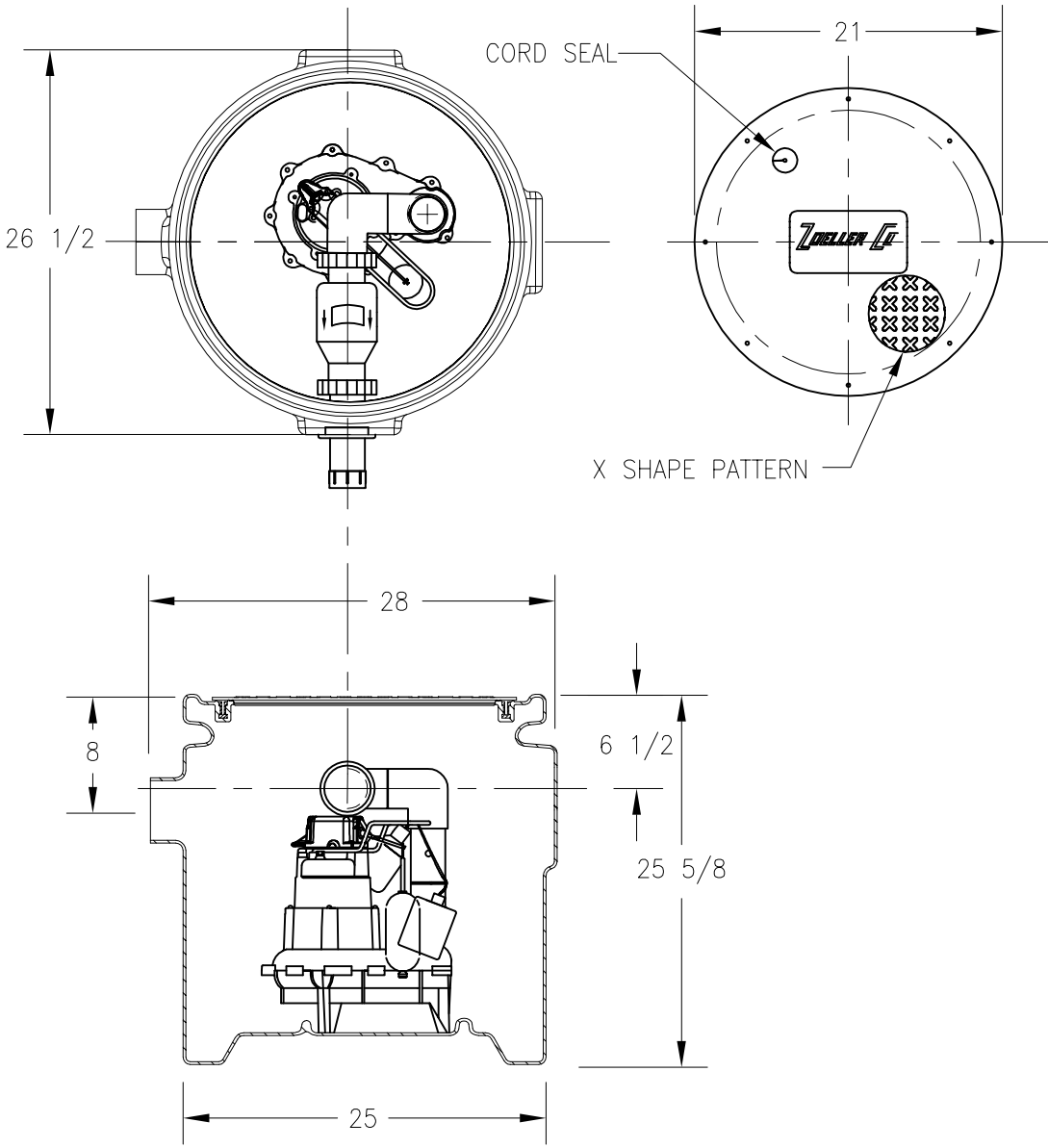

DO NOT SCALE PRINT		DRAFTER: D. DAVIS	6/13/08	TITLE: ARCHITECTURAL SPEC. DWG. 912 SEWAGE EJECTOR SYS. 24X24 PSF BASIN ZCO PROPRIETARY	
UNLESS OTHERWISE SPECIFIED DIMENSIONS ARE IN INCHES.		CHECKED:			
TOLERANCES:	DECIMALS	APPROVED:		P/N: ~	DWG. No.
	.X ± ~				
ANGLES ± ~	.XX ± ~				
FRACTIONS ± ~	.XXX ± ~			REV.: ~	
	.XXX ± ~				
	.XXXX ± ~				

- IMPORTANT -  
 NUMBERS ENCLOSED IN A CIRCLE; EXAMPLE (1), INDICATES A CRUCIAL SPECIFICATION THAT MUST BE ROUTINELY VERIFIED.