

External and internal application with external concrete stairwell Drawing No. (I P 005.1)

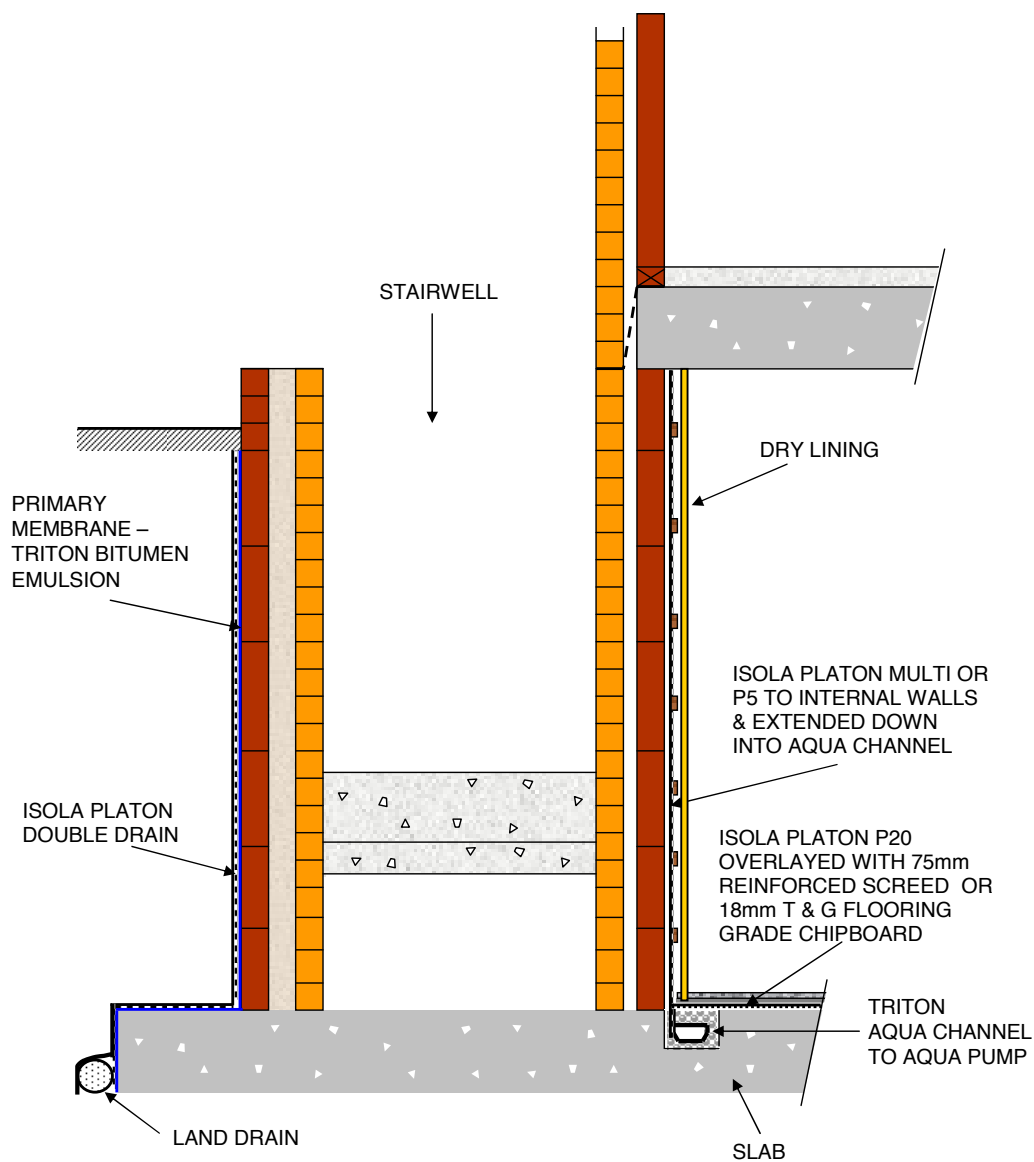

© Triton Chemical Manufacturing Company Limited

All installations to be strictly in accordance with manufacturer's guidelines which are set out in the Isola Manual. For any non-standard details, please contact our technical department on 020 8310 3929



Triton Chemical Manufacturing Co. Ltd.

Triton House, Lyndean Industrial Estate,

129 Felixstowe Road, Abbeywood, London SE2 9SG

Tel: 020 8310 3929 Fax: 020 8312 0349 Email: info@triton-chemicals.com

www.triton-chemicals.com